

Customisable

Easy & quick to install and service

Direct chill system PVDC

Timeless design: over 10 years sales record and yet still very popular

ACS, CE & WRAS certifications



Kalix: another name
for a modern and reliable
Point Of Use cooler



Welcome to the **Kalix** universe!

General Features

- **Multiple water options**
- **Two piece direct chill pressure vessel for ease of service**
- **Removable front panel for easy access to the filters**
- **Space for filling sports bottles, carafes**
- **Integrated cup dispenser**
(or flat top with no cup dispenser)
- **Soft touch buttons with indicator light**
- **Removable self-draining drip tray**
(Two-piece drip tray lifts out for easy removal. Molded for durability and dishwasher safe. Can be tapped to run to a waste drain)

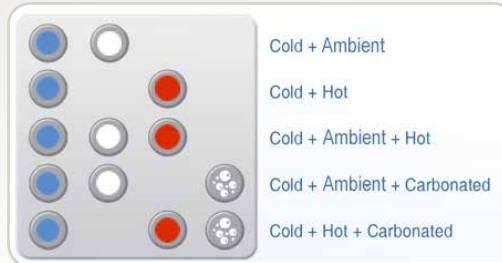

Technical Specification

Model		P1PVCDKY Ambient & Cold	P1PVCDHSY Hot & Cold	P1PVCDHSKY Hot, Ambient & Cold	P1PVECCDKY Ambient, Cold & CO2	P1PVECCDSY Hot, Cold & CO2
Weight (kg)		23.5	24.7	24.7	30.6	31.9
Cold tank capacity (litres)		1.5	1.5	1.5	1.5	1.5
Hot tank capacity (litres)		-	1.5	1.5	-	1.5
Dimensions (cm)	Height	112.0	112.0	112.0	112.0	112.0
	Width	32.0	32.0	32.0	32.0	32.0
	Depth	38.0	38.0	38.0	38.0 3	8.0
Power consumption (Watts)		100.0	620.0	620.0	100.0	620.0
Total current (Amps)		0.8	2.8	2.8	0.8	2.8
Cold water performance (litres/hr)	21°C ambient	20.0	20.0	20.0	20.0	20.0
Hot water performance (litres/hr)		-	7.9	7.9	-	7.9
CO2 performance		-	-	-	5.0	5.0

Multiple water options



Cooling System:

Kalix has the OASIS Pressure Vessel Direct Chill (PVDC) system. PVDC® is the most effective cooling system on the market.

The cooling tank is manufactured from 304 Stainless Steel and is kept under pressure that's why water is chilled within seconds.

Cold Water Refrigeration Unit: Convection cooled condenser. Internally spring mounted, hermetically sealed compressor with automatic overload protector. No lubrication needed. Refrigerant is controlled accurately by a capillary tube.

Cold Water Thermostat: Temperature is controlled by an adjustable thermostat with "Off" position that is easily accessible inside the filter compartment. OASIS direct chill pressure vessel: Two-piece, type 304 series stainless steel for easy cleaning and sanitizing.



Hot Water System:

A two-piece hot tank is used to aid in cleaning out scale. The hot tank is manufactured from 304 Stainless Steel which is non-corrosive and inert.

Two-Piece Hot Water Tank: The 500 watt element can be replaced on site, reducing time and service costs. Two piece hot tank is easily replaced or serviced.

Hot Water Thermostat: Adjustable thermostat with safety limiter.

Carbonated Water Circuit:

The pre carbonated cooled water is taken from the Pressure Vessel Direct Chill (PVDC) system, pressurised through a pump and mixed with CO₂ gas within a carbonator tank inside the OASIS PVDC system. The tank is made from food grade plastics and 304 Stainless Steel

350 litres with a standard 2kg cylinder



Installation options

Can be
factory
fitted

Auto drain Kit

With the new Kalix auto drain System the water from the drip tray is drained to your choice of a 2 or 5 litre storage container.

Once the storage container is full, a red float indicator rises above the surface of the drip tray, letting the user know it is time to empty the container.

The storage container can then be easily removed without any spills taking place.

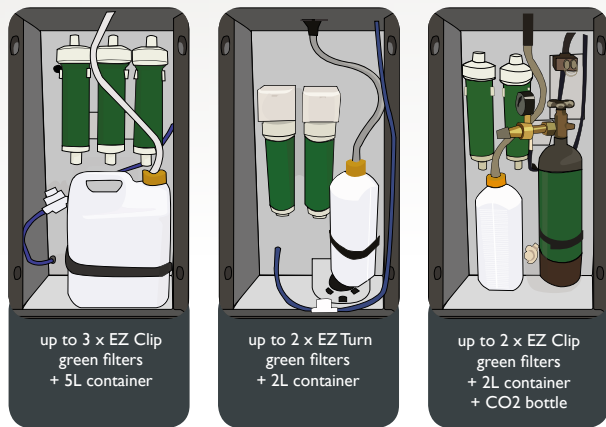

Autodrain system available

No more overflowing drip trays!

The new OASIS system conveniently drains the drip tray into a storage container inside the cooler.



POU installation Kit

POU installation kit Universal

Includes: isolation valve with double non return, pressure limiting valve, Water block leak-control device, JG 1/4" tubing

POU installation kit

Includes: isolation valve with double non return, Water block leak-control device, JG 1/4" tubing



CO2 bottles

OASIS can provide you with 2kg capacity CO2 cylinders that have been selected to fit inside the front compartment of the cooler.

- The total max height of CO2 bottle that can be fitted inside the compartment is 560mm (22.15") incl CO2 Regulator
- The max diameter of the CO2 bottle is 135mm (5.31")
- Larger CO2 bottles must be installed outside the cooler





OASIS[®]
Water Friendly Solutions

info@oasis.ie
www.oasis.ie